

# LEVELO

[AIR]



# LEVELO AIR

Dear Customer,

Thank you for choosing our company's "LEVELO Air" - outdoor air pump.

This product documentation explains how to assemble, use and maintain our LEVELO Air. All of our products are subjected to a function and quality test before they leave our factory. If however you experience any problems with this product, please feel free to contact our customer service department.

It is essential that this product is assembled in accordance with these instructions. Modifications to the product or improper use may affect product safety, function and service life!



# LEVELO AIRTABLE OF CONTENTS

Safety instructions	4
Warranty	4
Product information	5
Component description	5
Technical data	6
Instructons	7
Recommended tools	7
Safety instructions	7
Assembly steps	7
Functions	8
Pump Head	8
Pump head holder	8
Maintenance	9
Maintenance intervals	9
Replacing the valve head washer	10
Replacing the manometer unit and/or protective glass	10
Replacing the pump tube	12

# LEVELO AIR

## SAFETY INSTRUCTIONS

The LEVELO Air outdoor air pump must be installed and functionality checked through qualified personnel.

It is essential that you read and observe these instructions before assembling and maintaining the outdoor air pump.

Be sure to read the additional safety instructions in the assembly instructions (see the "Assembly Instructions" chapter on page 7).

Caution! Crushing hazard could occur during assembly or maintenance.

Children are not allowed to play with the LEVELO Air.

Modifications to the outdoor air pump or its components are prohibited.

Veyhl GmbH accepts no liability in the event of improper handling of LEVELO products.

## WARRANTY

For our LEVELO Air we provide a 12 month warranty.

The warranty covers all material and production defects and is valid from the production date (see nameplate, located behind the air pump casing (9) on the housing half (10)).

The warranty is only valid on condition that this product has been properly and professionally assembled and installed within the described parameters by trained personnel, that maintenance has been carried out correctly and that repairs have only been carried out using original Veyhl parts.

The product must not be operated or used improperly and without modifications, otherwise warranty and guarantee claims will be lost.

For further information, please refer to our General Terms and Conditions.

# LEVELO AIRPRODUCT INFORMATION

## COMPONENT DESCRIPTION

### Tools

1 x Veyhl-Tool

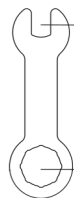

Pump handle (1)

Valve head nut (2)

1 x Safety bit(3)  
TX with hole  
C 6,3 (1/4)



### Valve head



Valve head nut (4)

Locking lever (5)

### Air pump

Pump handle (6)

Safety screw (7)

Strain relief (8)

Air pump casing(9)

Housing half (10)

Mounting slot (11)

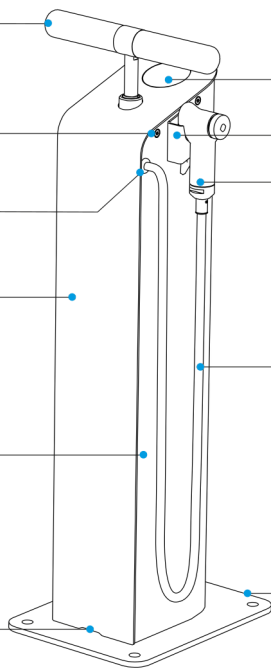

Manometer (12)

Pump head holder (13)

Valve head(14)

Steel flex tubing (15)

Mounting plate (16)

### Manometer holder

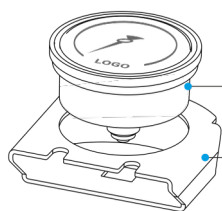

Complete manometer (17)

Manometer holder (18)

### Manometer Set

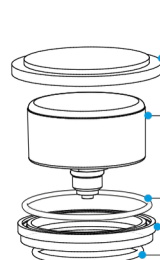

Protective glass(19)

Manometer (20)

Larger o-ring (21)

Housing ring (22)

Smaller o-ring (23)

# LEVELO AIRPRODUCT INFORMATION

## TECHNICAL DATA

Pump	V2A Outdoor public bike pump, vandalism safe and frost proof	Dimensions (B/L/H)	220 × 241 × 664 mm
Tire pressure	0-10 bar	Weight	12 kg
Pump head	Universal valve head (Presta, Schrader, Dunlop)	Material	Stainless steel
Pump tubing	Vandalism-resistant, with steel braided core	Coating	Outdoor powder coat (C4)
Manometer	Yes		

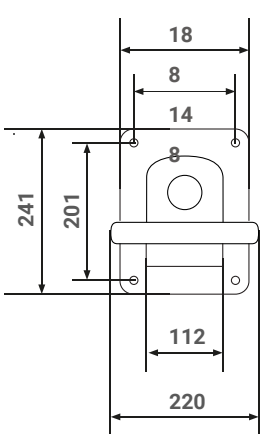
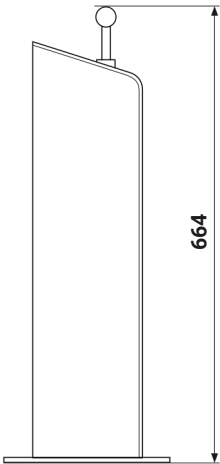
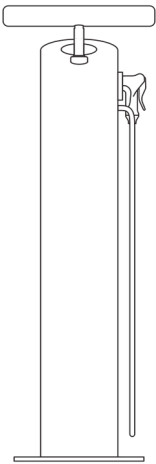

# LEVELO AIR INSTRUCTIONS

## SAFETY INSTRUCTIONS

Minimum distances to public roads must be maintained in accordance with applicable legal requirements.

All necessary approvals must be obtained e.g. excavation approvals, building applications and traffic regulations.

To secure the air pump in a theft-proof manner, we recommend a concrete foundation of the same size 50x50x20cm. This corresponds to a weight of approx 125 kg.

The LEVELO Air outdoor air pump may only be set up on a flat surface by qualified personnel. Make sure that the air pump is placed in a well-lit area.

Only use the supplied concrete hexagon head screws .

## RECOMMENDED TOOLS

- Hammer drill
- 6 mm concrete drill bit
- Tangential impact wrench, SW 13 mm



## ASSEMBLY STEPS

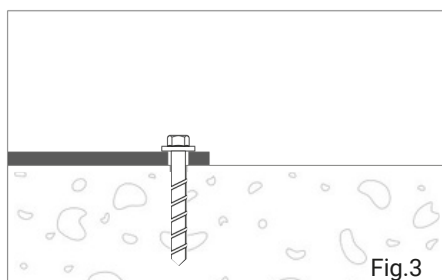
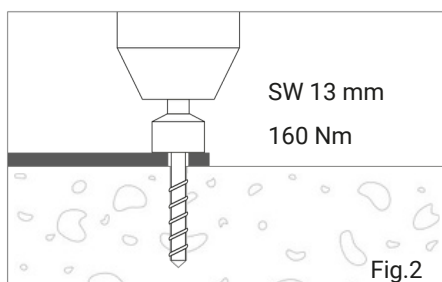
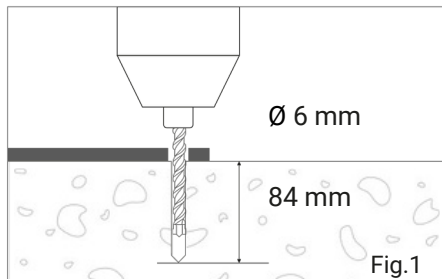

- 1 Remove the included assembly material from the overall packaging. The mounting material includes four concrete hexagon head screws.
- 2 Position the outdoor air pump on the prepared foundation and mark the holes with a waterproof pen.
- ! **Warning!** The included concrete hexagon head screws are suitable for concrete C20/25 to C50/60 (cracked and non-cracked), in prestressed concrete hollow slab ceilings and pressure-resistant natural stone. Please also note the manufacturer's information.
- 3 Using a 6mm concrete drill, drill 84mm deep into the foundation at the center of each of the four marks (Fig. 1). Then remove all dust and drill particles from the hole.
- 4 Now place the outdoor air pump on the holes so that they are congruent.
- 5 Now take the concrete screws, insert them into the holes and screw the screws tight with a tangential impact wrench and a wrench size of 13 mm at a torque of 160 Nm (Fig. 2).
- 6 The underside of the screw head must rest on the steel mounting plate of the LEVELO Air (Fig. 3).



# LEVELO AIR

## PUMP HEAD

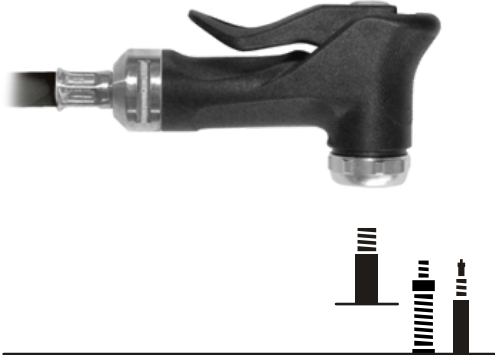

Open

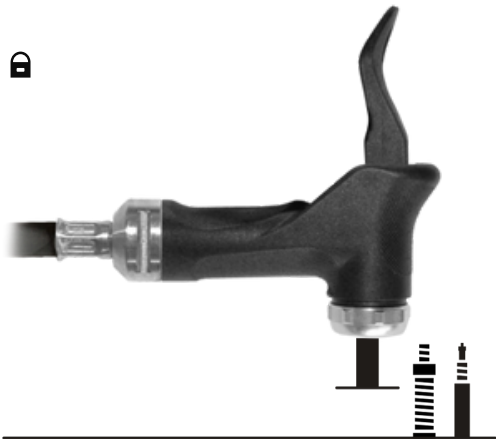

Closed

*Schrader, Presta, Dunlop*

## PUMP HEAD HOLDER

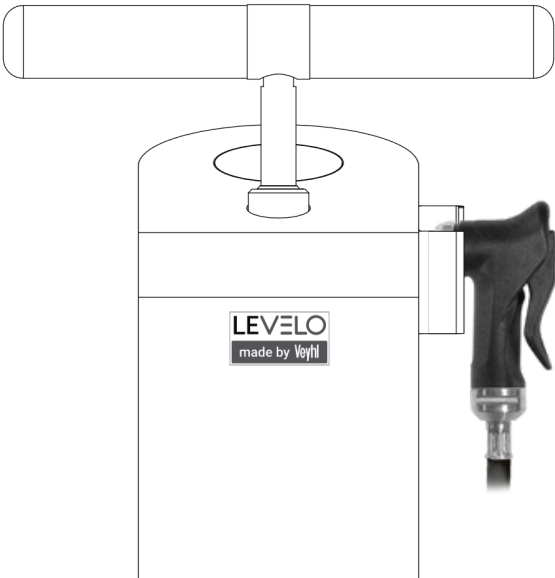
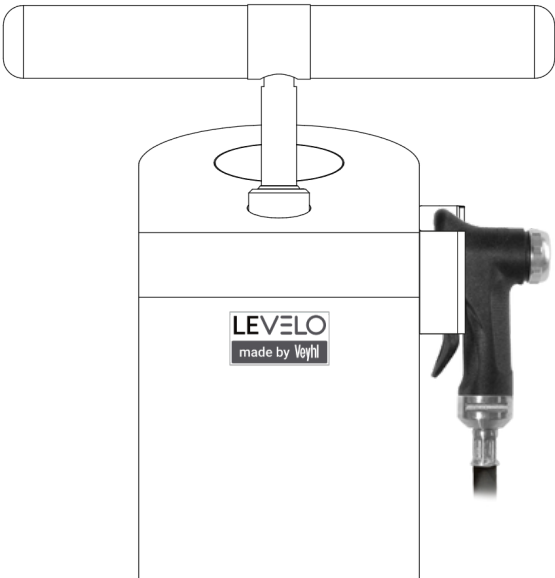



# LEVELO AIRMAINTENANCE

## MAINTENANCE INTERVALS

### Air Pump

	Frequency	Required time	Required tools	Spare part set
Replace pump head	If defect	5 minutes	slotted screwdriver	• Pump head incl. pump tube Art. Nr.: 1700703920
Replace valve head washer	Depending on frequency of use, every 3 months or if defect	2 minutes	Veyhl Tool (2)	• Valve head washer Art. Nr.: 1700703930
Pressure gauge unit	If defect	30 minutes	Veyhl Tool (1), safety bit (3), slotted screwdriver, open-end wrench 10 and 17 mm	• Pressure gauge unit Art.Nr.: 1700703660
Protective glass	If defect	30 minutes	Veyhl Tool (1), safety bit (3), slotted screwdriver, open-end wrench 10 and 17 mm	• Protective glass Art. Nr.: 1700703650
Pump tube	If defect	5 minutes	screwdriver, small Allen key	• Pump head incl. pump tube Art. Nr.: 1700703920

# LEVELO AIRMAINTENANCE

## REPLACING THE VALVE HEAD WASHER

- 1 Loosen the valve head nut (4) with the Veyhl tool (2) and replace the old valve head washer with the new one from the valve head washer spare parts set (Fig. 4). Then hand-tighten the valve head nut with the Veyhl tool.

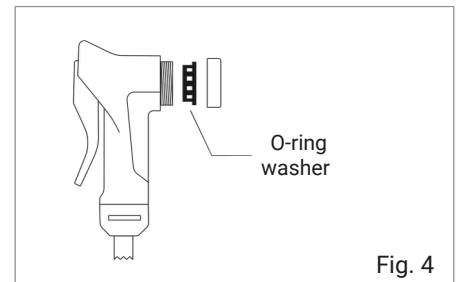

Fig. 4

## REPLACING THE MANOMETER UNIT AND/OR PROTECTIVE GLASS

- 1 To replace the complete manometer (17) or protective glass (19), you need the Veyhl Tool (1) and the manometer or protective glass spare parts set. First unscrew the pump handle (6). There are two notches for this directly under the handle on the bolt of the air pump. Hold the bolt with the Veyhl tool and unscrew the handle with your free hand (Fig. 5).
  - 2 Then loosen the four M4 Torx safety screws (7) on the anthracite-colored housing half (10) using the appropriate safety bit (3) (Fig. 6).
  - 3 There is a shallow slot at the bottom of the air pump casing (9). Carefully insert a slotted screwdriver into this slot (Fig. 8). Release the plate from the lock by pushing it slightly upwards. You can then push the plate further up by hand and remove it.
- ! To avoid damaging the surface of the casing, please cushion the screwdriver with a cloth. When pushing up the air pump cover, make sure that you do not accidentally tear out or pinch the hoses.

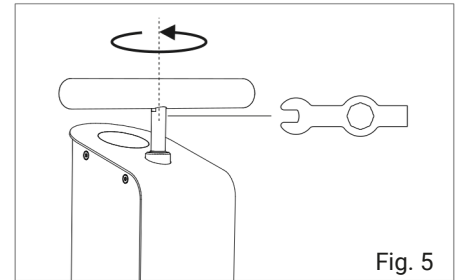

Fig. 5

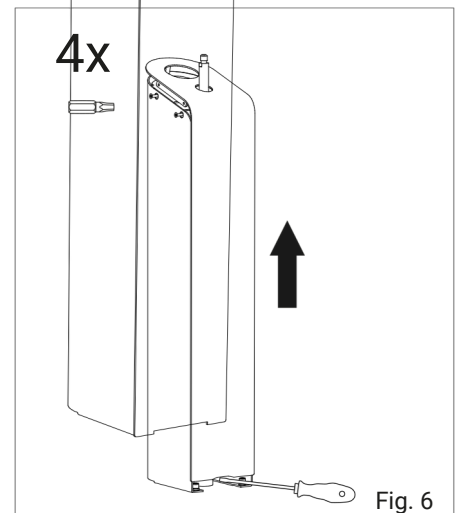

Fig. 6

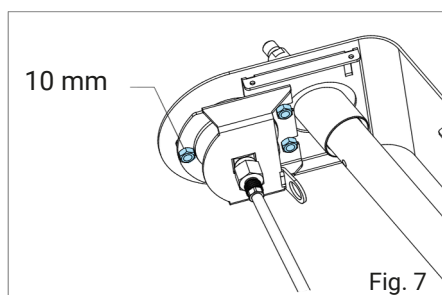

Fig. 7

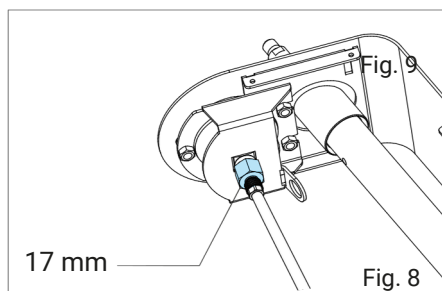

Fig. 8

- Replacing the manometer
- 4 When replacing the manometer (17), you must first unscrew the manometer holder (32) from the air pump casing (18). You will need a 10 mm open-end wrench for the three nuts (Fig. 7).
  - 5 Then use a 17 mm open-end wrench to loosen the screw-on fitting directly under the manometer at the tube attachment (Fig. 8).
- ! Caution! When removing the nuts, hold the manometer holder tightly with one hand.
- 6 Now install the new manometer (17) by placing the larger O-ring (21) in the groove of the new housing ring (22) at the top, placing the slightly smaller O-ring (23) in the manometer holder from below and sliding both over the new manometer from below (Fig. 9).

# LEVELO AIRMAINTENANCE

- 7** Remove the old manometer from the manometer holder and replace it with the prepared new unit.  
Make sure that you insert the manometer in the correct way. The manometer logo must be on the straight side of the manometer holder (Fig. 10). Now place the new protective glass (19) on the housing ring. The smaller diameter of the protective glass must be at the top. Continue with step 9 - Mounting the manometer.

## Replacing the protective glass

- 8** When replacing the protective glass (19), you only need to unscrew (step 4) the manometer holder (18) from the air pump casing (9) and replace the existing protection glass with the new one. When inserting the new protective glass, make sure that the small diameter is at the top (Fig. 9).

## Assembling the manometer

- 9** Fix the manometer holder and manometer using the three M6 hexagon nuts in the air pump casing. Hand-tighten the nuts using a 10 mm open-end wrench (Fig. 7).
- 10** Now connect the pump tube - if loosened - to the manometer and hand-tighten the screw-on fitting (with the 17 mm open-end wrench (Fig. 8)).
- 11** Now you can slide the air pump casing back over the housing until it audibly clicks into place and screw the four M4 safety screws on (Fig. 11) hand tight.
- 12** Finally, screw the pump handle back onto the bolt of the air pump. To do this, hold the bolt with the Veyhl tool and tighten the handle with your free hand (Fig. 5).

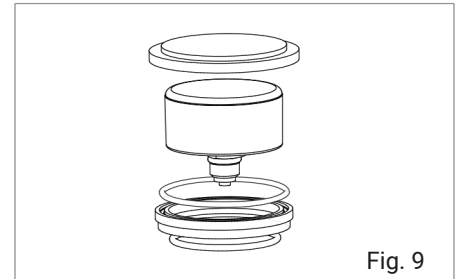

Fig. 9

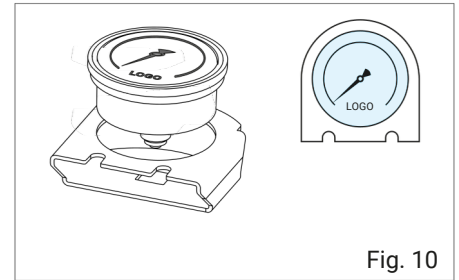

Fig. 10

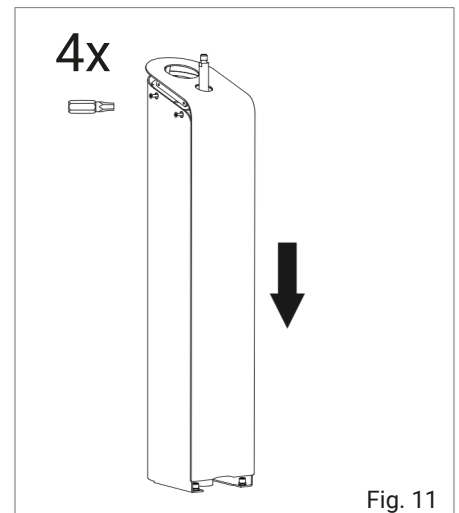
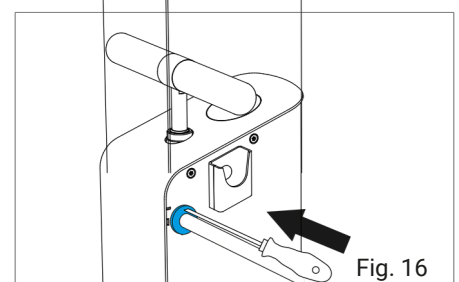
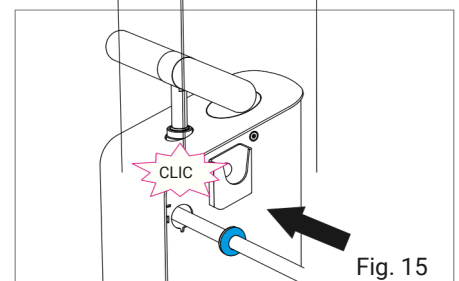
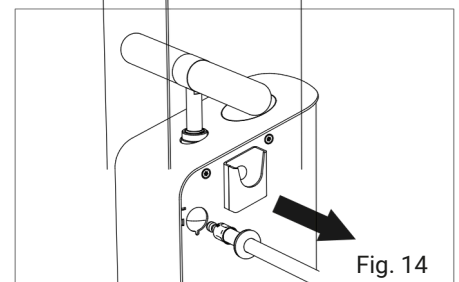
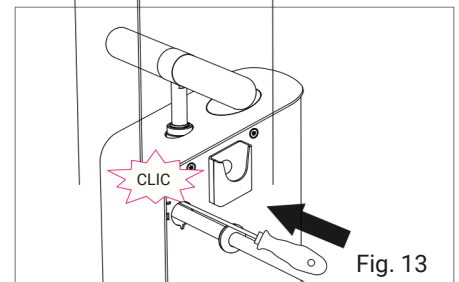
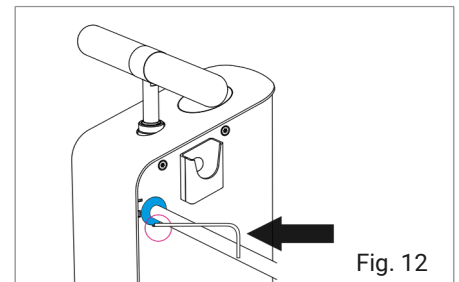

Fig. 11

# LEVELO AIRMAINTENANCE

## REPLACING THE PUMP TUBE

- 1 There is a small hole in the sheet metal below the sealing grommet of the pump hose (Fig. 12). Now take a small Allen key and insert it into the hole. Now carefully lever the hose nozzle out of the large sheet metal cut-out by exerting slight pressure in the direction of the hose and moving all the way round the nozzle with the Allen key. Slide the hose nozzle on the hose in the direction of the pump head.
- ! Caution: Risk of injury! To protect against vandalism, removing the sealing grommet is somewhat difficult!
- 2 Then insert a screwdriver parallel to the hose into the housing (Fig. 13). You will feel resistance after approx. 50 mm. Press firmly on this resistance with the screwdriver. When you hear a short click, the hose has come out of the fitting. You can now remove the hose and put it aside (Fig. 14).
- 3 Now prepare the new hose by putting the sealing grommet over the hose. You can now insert the new hose. Insert the hose into the empty opening. Push the hose into the fitting with slight pressure. You will hear a click when the hose engages in the fitting (Fig. 15).
- 4 Finally, insert the sealing grommet into the hole by applying slight pressure to the inner rubber edge and pressing the rubber into the hole so that the inner ring locks into place. You can also use the screwdriver for this (Fig. 16).





Stranger Solution GmbH  
Ennspark 2  
5541 Altenmarkt  
Austria

Telefon: +43 6452 5253 50  
[office@bike-energy.com](mailto:office@bike-energy.com)  
[www.bike-energy.com](http://www.bike-energy.com)